

Attention: _____

From: _____

Fax #: _____

PA Insert Quote or Job Number: _____

Customer: _____

Project: _____

Job Number: _____

Ship Date: ____ / ____ / ____

Date: ____ / ____ / ____

Page ____ of ____

TAP-ONS - PLASTIC AND STEEL

- FOR USE WITH PA INSERT PLASTIC AND STEEL THREADED INSERTS
- SECURE TO FORM WITH BOLT OR RIVET

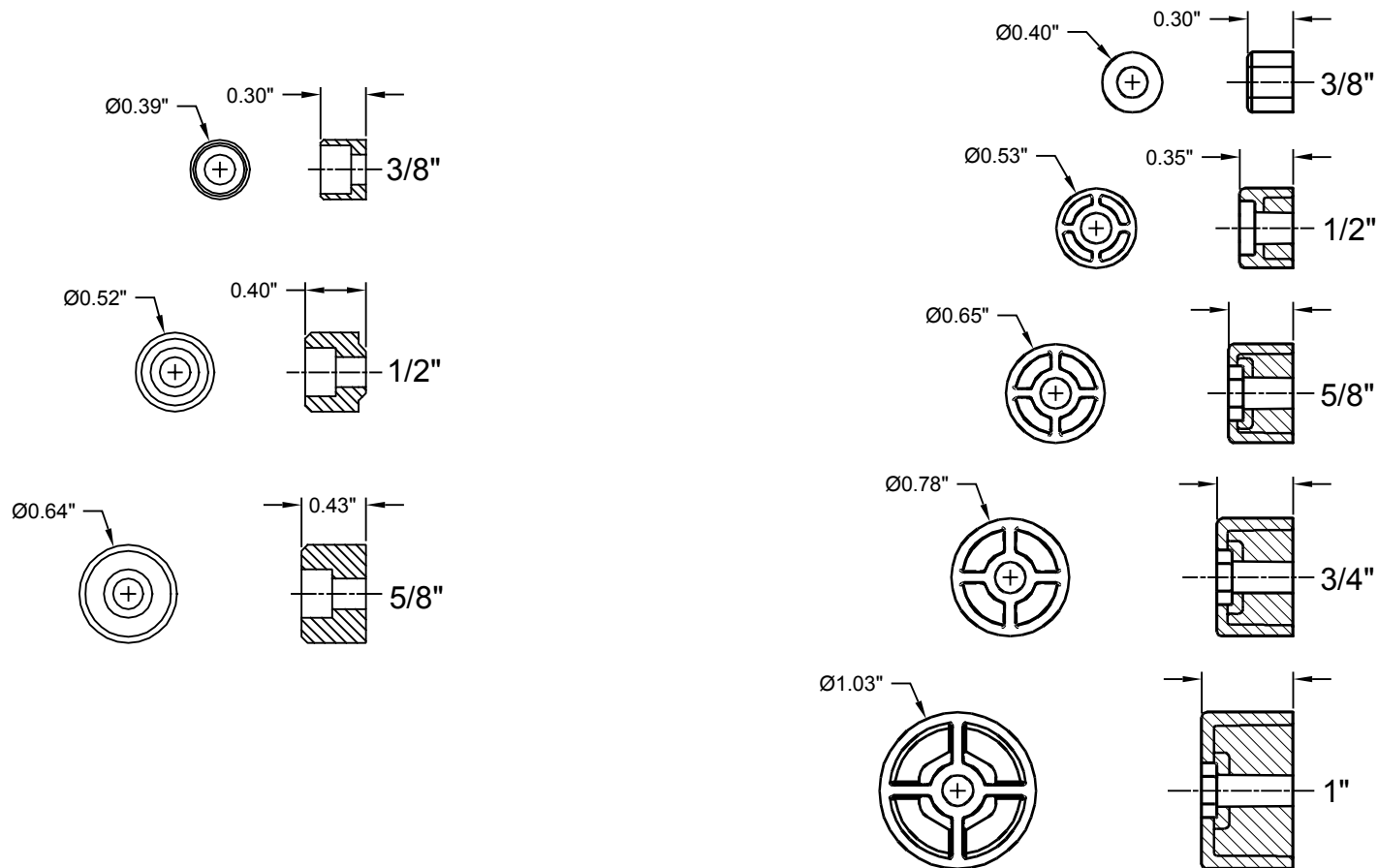

NO SCALE

06/09/04

Tap-Ons

Installation Instructions

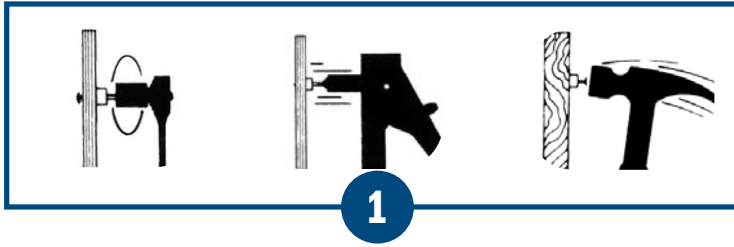

- 1** For installing a Hex Nut Insert with a Tap-On, it will be necessary to drill small holes in the form at the locations where inserts are desired. Measure and mark the form wherever an insert is needed and drill a 3/16" hole. Then, simply bolt, rivet, or nail the tap-on to the form.

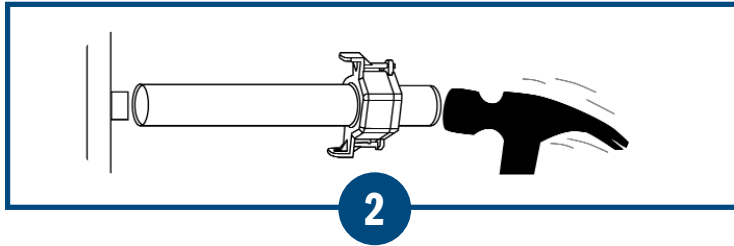

- 2** Tap Hex Nut Insert gently on to the tap-on. (Never hit the Insert hard and always wear safety glasses.)

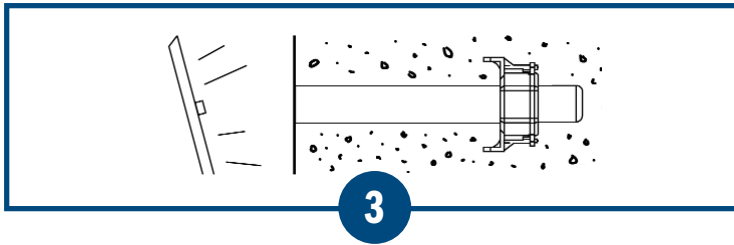

- 3** Tap-on will release when the form is stripped.

SAVES TIME & MONEY One of the great advantages of using tap-ons is their practicality and affordability for everyday use. For just a few cents tap-ons can save hours of formwork. Just nail, rivet, or bolt the tap-ons to the form with a 3/16" bolt. This saves drilling large holes in expensive steel forms. Best of all it makes installing the inserts a simple matter of tapping them onto the form. This is much faster and easier than threading and unthreading.

EASY TO USE Stick-Ons are perfect for those one time or special pours to avoid drilling holes in forms. Stick-Ons hold inserts to the form with remarkable strength. Because the insert is mounted directly in the center of the square Stick-On, precision placement is as simple as aligning the corners of the Stick-On with cross hair measurements.

USEFUL TIPS:

- Always wear eye protection when tapping inserts onto Tap-Ons.
- Tap gently.
- Make sure the form is free of oil and dirt before installing Stick-Ons. Cleaning with steel wool works very well.
- Caulk around the edges of Stick-On before oiling form so that oil does not seep behind part and compromise adhesion.

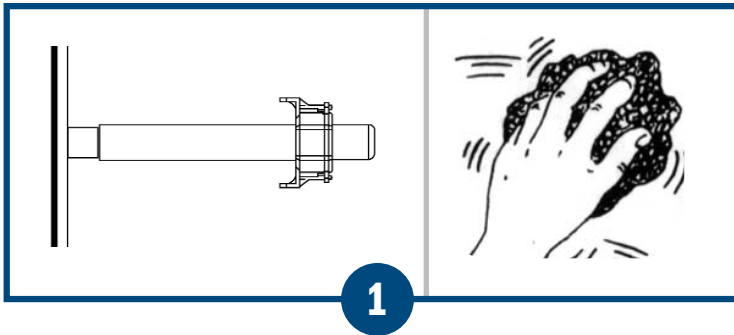

- 1** For installing a Hex Nut Insert with a Stick-On, simply attach the appropriately sized Tap-On to the Hex Nut Insert. Clean the mounting surface with steel wool and alcohol.

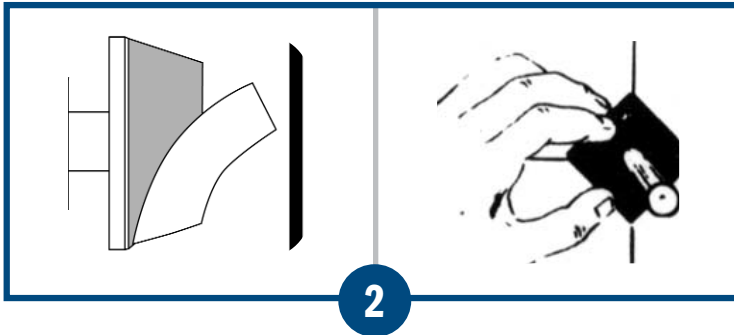

- 2** Peel the white backing off then press the Stick-On firmly in place using the corners of the Stick-On to align for critical placement.

SAVES TIME & MONEY One of the great advantages of using tap-ons is their practicality and affordability for everyday use. For just a few cents tap-ons can save hours of formwork. Just nail, rivet, or bolt the tapons to the form with a 3/16" bolt. This saves drilling large holes in expensive steel forms. Best of all it makes installing the inserts a simple matter of tapping them onto the form. This is much faster and easier than threading and unthreading.

EASY TO USE Stick-Ons are perfect for those one time or special pours to avoid drilling holes in forms. Stick-Ons hold inserts to the form with remarkable strength. Because the insert is mounted directly in the center of the square Stick-On, precision placement is as simple as aligning the corners of the Stick-On with cross hair measurements.

USEFUL TIPS:

- Always wear eye protection when tapping inserts onto Tap-Ons.
- Tap gently.
- Make sure the form is free of oil and dirt before installing Stick-Ons. Cleaning with steel wool works very well.
- Caulk around the edges of Stick-On before oiling form so that oil does not seep behind part and compromise adhesion.